



iR1435iF

iR1435

MULTIFUNCTIONAL PRODUCTIVITY NOW COMES IN COMPACT

Ideal for the Space-Conscious Business Environment

imageRUNNER 1435iF

- COPY/PRINT/COLOUR SCAN/SEND/FAX
- 35PPM • UFR II LT • SCAN TO EMAIL/
NETWORK FOLDER/USB • NETWORK-
READY • SECURE PRINT

imageRUNNER 1435

- COPY / PRINT / COLOUR PULL SCAN
- UFR II LT • SCAN TO USB • 35 PPM
- NETWORK-READY • SECURE PRINT

AN INTELLIGENT MULTIFUNCTION DEVICE THAT DELIVERS AN INDUSTRIOUS PERFORMANCE

Heavy-Duty Print Capabilities

Made possible by Canon's Ultra Fast Rendering (UFR II LT) technology, the imageRUNNER 1435iF and imageRUNNER 1435 achieve a print speed of 35ppm (A4). A new imageRUNNER controller further enables high-speed image processing and rendering to realise higher quality prints at faster speeds. With a redesigned paper path and toner fixing at low temperatures, printouts are delivered crisp with minimal paper curl.

Efficient and Smart Copying

The ID Card Copy function makes it foolproof to copy the front and back of a card or license onto one page, thus reducing the number of pages printed and saving costs.

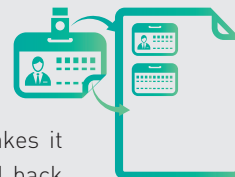

Save printing
cost by forwarding all
your incoming faxes



imageRUNNER 1435



imageRUNNER 1435iF



Email addresses



Network folders
in file servers



Effortless Fax Function*

Manage your fax traffic with the Fax Forwarding function which lets you forward all or selected incoming faxes to another fax number, email addresses or shared folders in file servers. This function is a great saver on printing costs and storage space as you do not need to print every incoming fax.

With the archiving sent fax function, faxes that were successfully sent will automatically be stored in a preset destination such as email addresses or network folders.

*Only available on the imageRUNNER 1435iF

Colour Scanning Convenience

Scan and save documents directly into a USB memory device in PDF, JPEG or TIFF formats. The imageRUNNER 1435iF can perform Colour Push Scan to multiple destinations of one type, such as email and network folder. You can save yourself plenty of time by designating multiple destinations for your original scans without having to repeat the process.

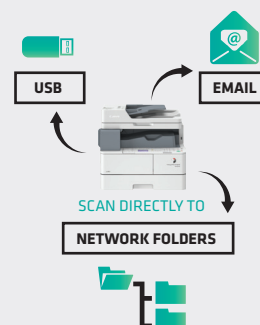

NETWORK-READY, MOBILE-FRIENDLY



The imageRUNNER 1435iF and imageRUNNER 1435 are designed to fit seamlessly into your existing network infrastructures. With support for IPSec, IEEE 802.1x and IPv6, the devices provide various network security to further protect your confidential information.

To print or scan photos, web pages and documents from the imageRUNNER 1435iF or imageRUNNER 1435 with your mobile device, download the free Canon Mobile Printing app and the Canon Mobile Scanning for Business app from the App Store or Google Play.

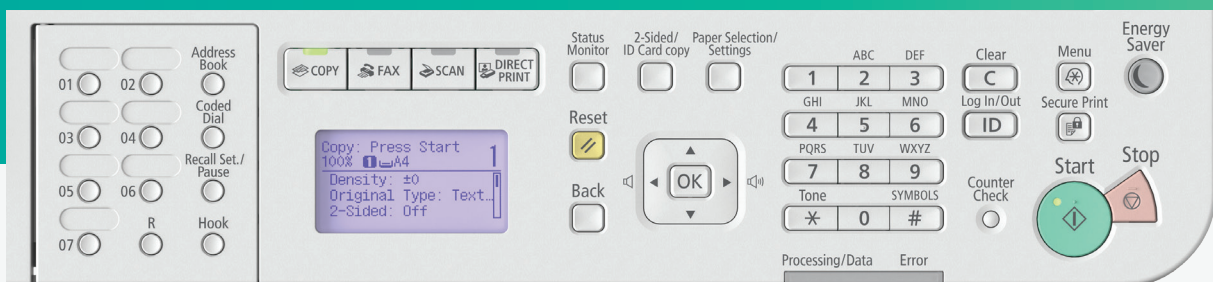

Operational Panel of imageRUNNER 1435iF

Enhanced Device Management & Security



Configure access and function restrictions for up to 300 registered Department IDs with the **Department ID Management function**. You can track print and copy usages, restrict certain functions and assign selective access privileges.



The **Secure Print function** keeps confidential documents private by allowing you to set a PIN when printing from your computer. The document is held in the device's memory and not printed until you have input the correct PIN on the operation panel of the device.



With built-in **Remote UI**, you can access and manage the device remotely from a web browser on your computer. **e-Maintenance service** helps you keep track of consumables and automatically places a re-order request for items that are running low directly to relevant service centres.

SPECIFICATION

iR1435

iR1435iF

GENERAL SPECIFICATIONS		iR1435	iR1435iF
Type	A4 Monochrome Multifunctional Device (Reader/Printer/Desktop)		
Copy/Print Speed	35 ppm (A4)		
Warm-Up Time	20 seconds or less		
Recovery from sleep mode	7.8 seconds or less		
First Copy Time	6.9 seconds or less	7.9 seconds or less	
Processor Speed	533 Mhz		
Memory	512 MB		
Interface	Network	10Base-T, 100Base-TX, 1000Base-T	
	Others	USB2.0 x 1 USB1.1 x 1	
Dimensions (H x W x D)	422.5 mm x 545 mm x 457 mm	475.3 mm x 545 mm x 457 mm	
Weight	Approximately 22.34kg	Approximately 23.74 kg	
Installation Space (W x D)	772.1 mm x 457 mm (when the multi-purpose tray is extended)		
Power Supply	220 to 240 V AC, 50/60 Hz, 3.8 A		
Max Power Consumption	1.5 kWh or less		
Toner Yield (A4, 6% coverage)	17,600		
Drum Yield	35,500		
PRINT SPECIFICATIONS			
Print Resolution	600 x 600 dpi		
Paper Input Capacity (Standard)	Cassette 1	500 sheets (80 gsm)	
	Multi Purpose Tray	100 sheets (80 gsm)	
Paper Input Capacity (Optional)	Cassette 2	500 sheets (80 gsm)	
	Multi Purpose Tray	60-128 gsm	
Page Description Language(s)	UFR II LT (Standard), PCL5e/6 (Optional), Adobe PostScript 3 (Optional)		
Operating System compatibility	UFR II LT	Windows XP, Windows Vista, Windows 7, Windows 8, Windows 8.1, Windows Server 2003, Windows Server 2008, Windows Server 2008 R2, Windows Server 2012, Windows Server 2012 R2, Mac OS X 10.5, 8 and later	
	PCL	Windows XP, Windows Vista, Windows 7, Windows 8, Windows 8.1, Windows Server 2003, Windows Server 2008, Windows Server 2008 R2, Windows Server 2012, Windows Server 2012 R2	
	PS	Windows XP, Windows Vista, Windows 7, Windows 8, Windows 8.1, Windows Server 2003, Windows Server 2008, Windows Server 2008 R2, Windows Server 2012, Windows Server 2012 R2, Mac OS X 10.5, 8 and later	
Network Protocol	TCP/IP (IPv4/IPv6) Frame type: Ethernet II Print applications: LPD/Raw/IPP/WSD/SMB		

COPY SPECIFICATIONS		iR1435	iR1435iF
Copy Resolution	600 x 600 dpi		
Paper Input Size	Cassette 1 (Standard)	A4R	
	Cassette 2 (Option)	Type A4: A4R Type U: A4R, FOOLSCAP	
	Multi Purpose Tray	A4R, A5R, B5R, A-FLS, FOOLSCAP, 16K, Envelope (C5/DL/COM-10/Monarch)	
Multiple Copies/Prints	Up to 999 copies		
Reduction/Enlargement	Copy Ratio	Zoom: 25-400% in 1% increments Fixed Zoom Ratio: 25%, 50%, 70%, 100%, 141%, 200%, 400%	

COLOUR SCAN SPECIFICATIONS			
Scan Resolution	BW/Colour: 300 x 600 dpi, 600 x 600 dpi		
Scan Speed (A4, 300 dpi)	1 sided	BW: 28 sheets/minute	
		CL: 10 sheets/minute	
Scan Resolution	300 x 600 dpi, 600 x 600 dpi		
Push Colour Scan	N/A	Email (SMTP), Network folders (SMB, FTP)	
	USB Memory Media		
Pull Colour Scan/Remote Scan	ScanGear MF, application compatible with TWAIN/WIA		
Address Book	LDAP, Local (Max. 300)		
File Format	PDF, PDF (Compact), PDF (OCR), PDF (Compact/OCR), JPEG, TIFF		

FAX SPECIFICATIONS			
Applicable Line	N/A	PSTN	
Modem Speed	N/A	Super G3: 33.6 kbps, G3: 14.4 kbps	
Fax Resolution	N/A	Normal, Fine/Photo, Superfine, Ultrafine	
Fax Speed Dial	N/A	19 one-touch, 281 coded-dials, 299 group dials	
Address Book Capacity	N/A	Address Book: 300 destinations (including destinations stored in one-touch keys)	
Compression Method	N/A	MH, MR, MMR, JBIG	
Fax Memory Capacity	N/A	Approx. 512 pages	
Memory Lock PIN	N/A	Yes	
PC-fax	N/A	Yes	
Remote Reception	N/A	Yes (Default ID: 25)	
Auto Receive Reduction	N/A	Yes (75%-100%)	
Auto Double-sided Fax Print	N/A	Yes	

OPTIONAL ACCESSORIES			
CASSETTE MODULE - AC1 U			
Paper Sizes	A4R, FOOLSCAP		
Paper Capacity	500 sheets (80gsm)		
Dimensions (H x W x D)	154.8 mm x 520 mm x 450.8 mm		
CASSETTE MODULE - AC1 A4			
Paper Sizes	A4R		
Paper Capacity	500 sheets (80gsm)		
Dimensions (H x W x D)	154.8 mm x 520 mm x 450.8 mm		

OTHER OPTIONAL ACCESSORIES AND SUPPLIES			
FL Cassette-AW1 A4, FL Cassette-AW1 U, Cassette Heater Unit-39, Copy Card Reader-F1, Copy Card Reader Attachment-E1, PCL Printer Kit-BA1, PS Printer Kit-BA1, USB Direct Print Kit (for PDF)-K1, Barcode Printing Kit-D1, Send PDF Security Feature Set-E1, Copy Control Interface Kit-A1			

DEALER'S STAMP



To arrange for a demonstration, simply contact any of our offices below.

SOUTH & SOUTHEAST ASIA REGIONAL HEADQUARTERS

Canon Singapore Pte. Ltd.

1 HarbourFront Avenue #04-01, Keppel Bay Tower, Singapore 098632
Tel: +65-6799 8888 | Fax: +65-6799 8882 | www.canon-asia.com | www.canon.com.sg

CANON SALES SUBSIDIARIES & BUSINESS PARTNERS

Afghanistan:
Megaplus Afghanistan Limited House
No. 233, Street No. 4, Charagh Ali,
Qilla-e-Fatehullah, Kabul, Afghanistan
Tel : 93-700 228 832 / 93-700 979 511
Fax : 93-202 201 259
Email: info@megaplus.com.af

Bangladesh:
Flora Limited
Adamjee Court Annex-2 (4th Floor)
119-120 Motijheel Commercial Area
Dhaka 1000 Bangladesh
Tel : 880-2-716-2742-46 / 225
Fax : 880-2-955-0030
www.floralimited.com

Brunei:
Interhouse Company
No. 5-7 Bunut Jaya Complex
Spq 574 Jalan Tutong BF1320
P.O. Box 423, Seri Complex
Bandar Seri Begawan BA 1779
Brunei Darussalam
Tel : 673-2-653-001
Fax : 673-2-653-003

Cambodia:
Royal Cambodia Co., Ltd
#437 Preah Monivong Blvd
Phnom Penh
Kingdom of Cambodia
Tel : 855-23-428955
Fax : 855-23-722961

Hong Kong:
Canon Hongkong Co. Ltd
19F, The Metropolis Tower
10 Metropolis Drive
Hungghom, Hong Kong
Tel : 852-3191-2388
Fax : 852-2369-3800
www.canon.com.hk

India:
Canon India Private Limited
7th Floor, Tower B, Building #5
DLF Cyber Terraces, DLF Phase-3
Gurgaon - 122002
Haryana, India
Tel : 91-124-416 0000
Fax : 91-124-416 0011
www.canon.co.in

Indonesia:
PT Samafitro
Jalan Ir. H Juanda No.8
Jakarta 10120, Indonesia
Tel : 62-21-345 8989
Fax : 62-21-345 6699
www.samafitro.co.id

Malaysia:
Canon Marketing (Malaysia) Sdn Bhd
Block D, Peremba Square
Saujana Resort Section U2,
40150 Shah Alam
Selangor Darul Ehsan, Malaysia
Tel : 60-3-7844 6200 / 7845 0055
Fax : 60-3-7844 6196 / 6198
www.canon.com.my

Maldives:
Simdi Company Pvt Ltd.
G.Manaam Building,
2/1 Neelofaru Magu,
Male* 20-129, Maldives
Tel : 960-333 4421
Fax : 960-333 4424

Myanmar:
Myanmar Golden Rock International Co., Ltd
No. 79-D, Bo Chein Street, Pyay Road,
6 1/2 Mile, Hlaing Township,
Yangon, Myanmar
Tel : 95-1-654810 to 19 (10 Lines),
95-1-654844 to 48 (5 Lines)
Fax : 95-1-654820
Email: sales@mgr.com.mm

Nepal:
International Electronics Concern (P) Ltd
Kha 14, 1st Floor
Haratibhawan Putalisadak
Ramshah Path, Kathmandu, Nepal
P.O. Box 12588
Tel : 977-1-442 1991
Fax : 977-1-442 1909

Pakistan:
Shirazi Trading Company (Pvt.) Ltd
8th Floor, Adamjee House
I.I. Chundrigar Road
Karachi 74000 Pakistan
Tel : 92-21-3241 (7659), (7737) or (7746)
Fax : 92-21-(3241 7747), (3242 0417)
or (3242 0418)
www.shirazitrading.com.pk

Philippines:
Canon Marketing (Philippines), Inc.
Ground Floor Commerce and Industry Plaza,
Campus Ave. Cor. Park Ave., McKinley Hill
Fort Bonifacio, Taguig City
Tel : 632-884-9000
Fax : 632-556-1456
www.canon.com.ph

Sri Lanka:
Metropolitan Office (Pvt) Ltd
12, Magazine Road Colombo 08
Sri Lanka
Tel : 94-11-470 0200
Fax : 94-11-470 0267
www.metropolitan.lk

Taiwan:
Canon Marketing (Taiwan) Co. Ltd
19F, No. 100, Sec.2 Roosevelt Road,
Taipei, Taiwan, R.O.C.
Tel : +886 2-6632-8888
Fax : +886 2-6632-6700
www.canon.com.tw

Thailand:
Canon Marketing (Thailand) Co. Ltd
No.98 Sathorn Square Office Tower,
22nd - 24th floor, North Sathorn Road,
Silom, Bangrak, Bangkok 10500
Tel : 66-2-344 9999
Fax : 66-2-344 9960
www.canon.co.th

Vietnam:
Canon Marketing (Vietnam) Co. Ltd
Level 10, President Place, 93 Nguyen Du,
Dist 1, Ho Chi Minh City, Vietnam
Tel : 84-8-3820 0466
Fax : 84-8-3820 0477
www.canon.com.vn

This brochure and the specifications of the product have been developed prior to the date of product launch. These specifications are subject to change without notice. Therefore no representations or warranties, either express or implied, are made of the fitness of this product for a particular purpose. In no circumstances shall the information in this brochure be considered part of our terms and conditions of sale. You are advised to check the prevailing specification immediately prior to purchase. All company and/or product names are trademarks and/or registered trademarks of their respective manufacturers in their markets and/or countries.

Canon, imageRUNNER, imageRUNNER ADVANCE, imageCHIP, RAPID Fusing System, eMaintenance, iW, Business can be simple and get Smart get genuine are trademarks of Canon Inc. and/or its affiliates. Other names may be the trademarks of their respective owners.

uniFLOW, eCopy and Therefore are independent party software distributed by Canon Singapore Pte. Ltd.